

EASINE

by ILIFE

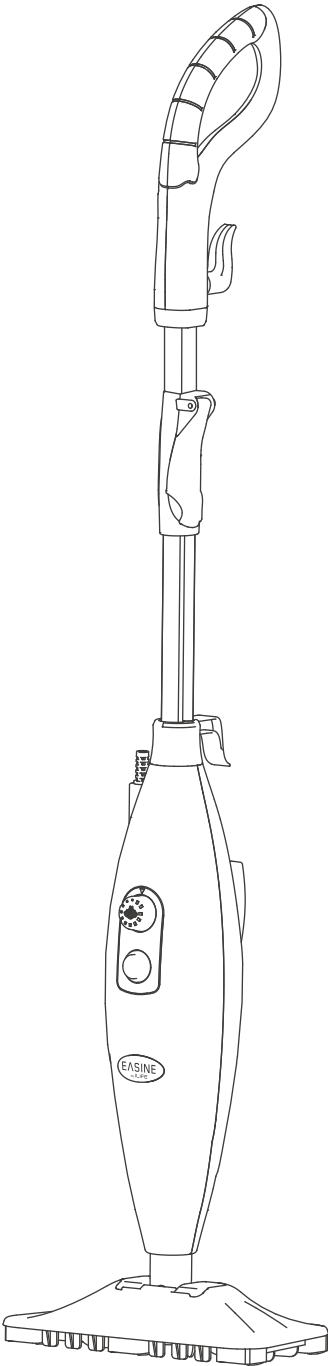

S50 | Steam Mop

User Manual

Thank you for choosing EASINE S50 steam mop !

You've joined millions of people to get the cleaning done in high efficiency.

This manual helps you to keep your steam mop performing at its best. Please take a few moments to read through it.

You may also connect us on Facebook and Instagram to enjoy exclusive benefits:

- Get model-specific customer support, including Q&A, maintenance tips, demo videos, live chat and more;
- Get the most recent product updates including new product launches, exclusive discounts and special promotions.

You may find us on:

Facebook: facebook.com/Easine

Twitter: twitter.com/EASINE_Global

If you have any questions, please contact our customer service for assistance or visit www.easine.com for more information.

Enjoy the high-performance cleaning of EASINE S50.

EASINE Innovation

EASINE Customer Service

Russia

 **89299401228** (Mon-Fri: 9:00 - 18:00)

 support-russia@easine.com

Other countries

 support-europe@easine.com

Contents

1. Important Safety Instructions	1
2. Product Composition	3
2.1 Product layouts	3
2.2 List of accessories	4
3. Product Operation	5
3.1 Assembly instruction	5
3.2 Fill water guide	6
3.3 Using your steam mop	7
4. Maintenance	9
4.1 Automatic shutdown function	9
4.2 Maintenance skills	9
5. Common Failure Analysis and Treatment	10
5.1 Care of your steam mop	10
5.2 Care of your micro-fiber cleaning pad	10
5.3 Troubleshooting	11
6. Product Technical Parameters	12
7. Disposal Information	13

For household use only

When using your steam-care mop, basic safety precautions should always be followed, including the following:

- Read all instructions before using your steam mop.
- Please be careful when using the steam mop, the steam emitted from the steam mop is very hot.



WARNING: TO REDUCE THE RISK OF FIRE, ELECTRIC SHOCK OR INJURY.

WARNING

1. Use the system only for its intended use.
2. Do not use outdoors.
3. Do not leave the appliance unattended when plugged in. Always unplug the power cord from the electrical outlet when not in use and before servicing.
4. Do not allow the appliance to be used by children. Close attention is necessary when used by or near children, pets or plants.
5. Use only as described in this manual.
6. Use only manufacturer's recommended accessories.
7. Do not operate the appliance with a damaged plug or cord, or if the unit has been dropped or damaged. To avoid the risk of electric shock, do not disassemble or attempt to repair the appliance on your own. Return the appliance to EASINE after sale products limited for examination and repair. Incorrect re-assembly or repair can cause a risk of electrical shock or injury to persons when the appliance is used.
8. To protect against a risk of electric shock. Do not immerse the steam mop into water or any other liquids.
9. Do not handle plug or steam mop with wet hands or operate appliance without shoes.
10. Do not pull or carry by power cord, use power cord as handle, close a door on the power cord, or pull the power cord around sharp edges or corners. Keep power cord away from heated surfaces.
11. Do not unplug by pulling on power cord. To unplug, grasp the plug not the power cord. Do not use extension cords or outlets with inadequate current carrying capacity.
12. Do not put any objects into openings. Do not use with any opening that is blocked.

Important Safety Instructions

13. Do not touch mop head and body when using to avoid burns as temperature is high.
14. Use only on flat, horizontal surfaces, Do not use on walls, counters or windows.
15. Do not use on leather, wax polished furniture or floors, synthetic, fabrics, velvet or other delicate, seam sensitive materials.
16. Do not add cleaning solutions, scented perfumes, oils or any other chemicals to the water used in this appliance as this may damage the unit or make it unsafe for use. If you live in a hard water area, we recommend using distilled water in your steam mop.
17. When in use, never turn the appliance over or on its side. Never direct steam towards people, animals or plants.
18. Never leave the steam mop in one spot on any surface for any period of time when micro-fiber pad is attached as this will damage your floors.
19. Carefully remove the micro-fiber cleaning pad after you have unplugged and allowed the steam mop to cool.
20. When cleaning the steam mop, unplug the power cord from the electrical outlet and clean with a dry or damp cloth. Do not pour water or use alcohol, benzene or paint thinner on the unit.
21. Extreme caution should be exercised when using this appliance to clean stairs.
22. Never use steam mop without micro-fiber cleaning pad attached.
23. Keep your work area well lit.
24. Store steam mop indoors in a cool, dry place.
25. To avoid circuit overload, do not operate another appliance on the same socket (circuit) as the steam cleaner.
26. If an extension cord is absolutely necessary, an extension cord rated a minimum of 15A, 3*0.75mm cord should be used. Cords rated for less amperage may overheat. Care should be taken to arrange cord so that it cannot be pulled or tripped over.
27. Always unplug and allow the steam mop to cool before removing or changing mop heads.

Product layouts

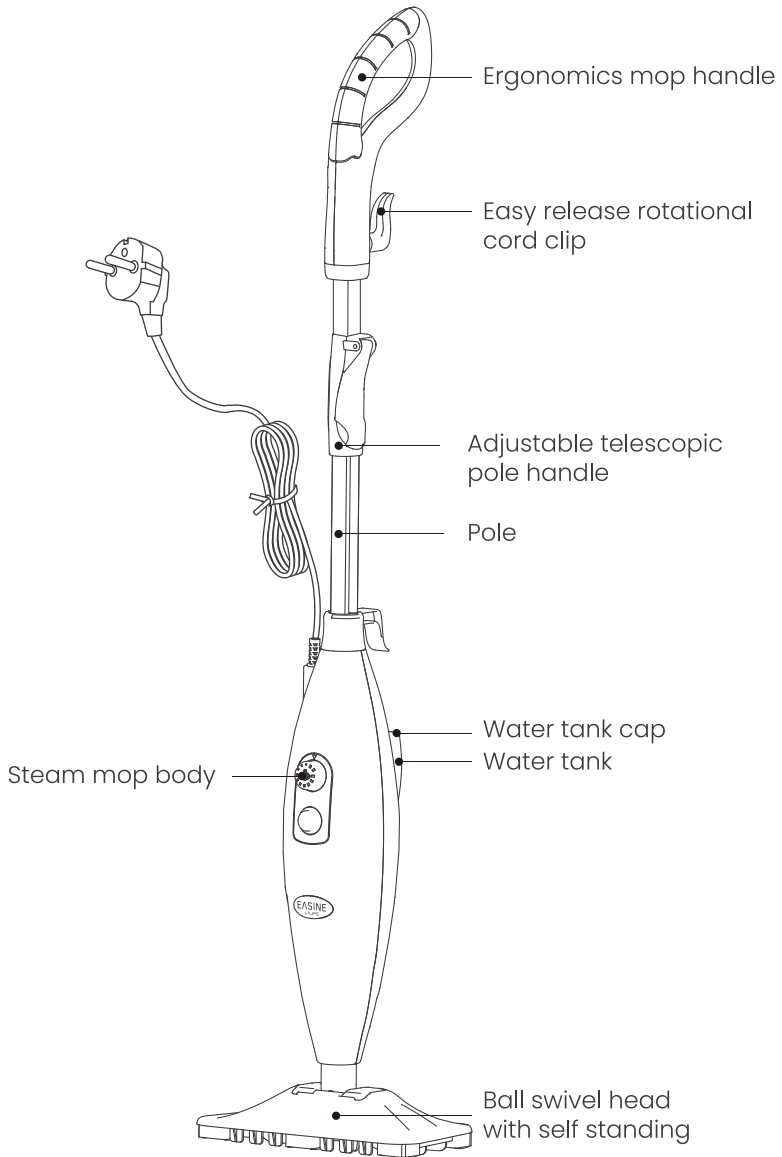

Product Composition

List of accessories

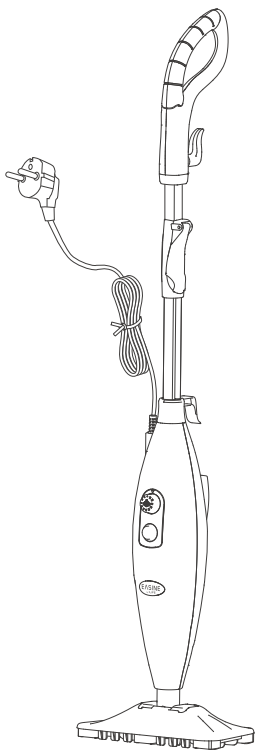

Main Body

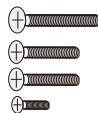

Screws



hopper



User Manual

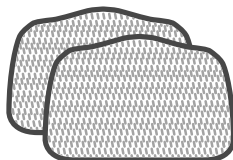

Terry micro-fiber pad x 2



Attention!

Phillips of flat head screwdriver can be used. Screwdriver not included.

Assembly instruction

When assembling your steam mop there may be a little water in or around the water tank . This is because we test all our steam mops 100% before you buy them,so you get a high quality EASINE S50 steam mop.

- 1 Connect the handle with the pole, then take the screws (M4×30mm) from the included screw bag and install as shown.

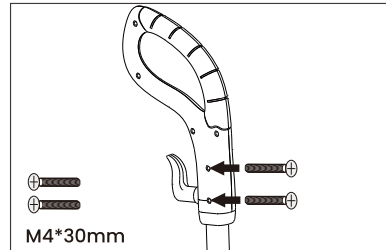

- 2 Connect the pole with the body, then take the screws (M6×45mm) from the included screw bag and install as shown.

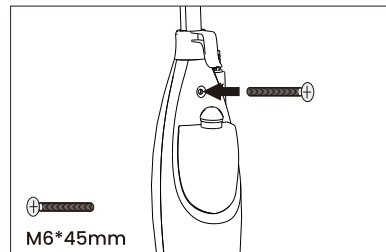

- 3 Connect the mop head with the body, then take the screws (M4×10mm) from the included screw bag and install as shown.

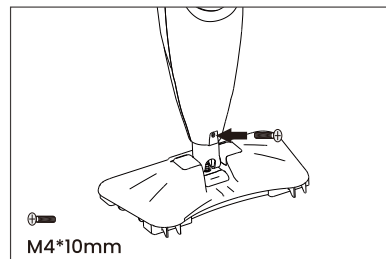

Product Operation

Fill water guide

! Attention!

1. First things first, always make sure the mop is UNPLUGGED from the wall when not in use.
2. Never fill the mop, attach the mop head, change or remove the micro-fiber cleaning pad when the mop is plugged into the wall.
3. To prolong the life of your steam-care steam mop, we recommend using distilled water.
4. Make sure you only add water to the tank.
5. Chemicals or cleaning solution may damage the appliance and could be unsafe for you and your family.
6. Do not add any aromatic chemicals, cleaning solution, disinfectant fluid into water tank.

- 1 Turn and remove the knob from the water tank as shown.

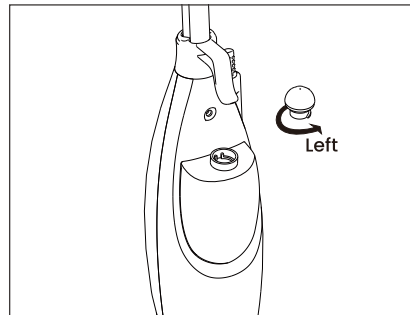

- 2 Pour water into water tank to the water line.

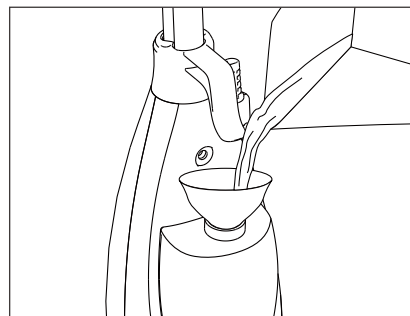

- 3 Insert the knob back to the water to the water tank and turn to lock up.

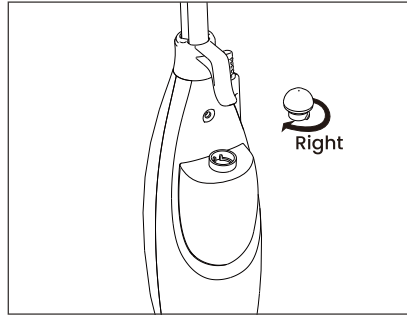

Using your steam mop

! Attention!

- 1. When you are using the mop for the first time, it might make longer than the normal 20 seconds to start steaming.
- 2. Your steam mop needs water to make steam. Never use your steam mop without water in the tank. Sweep or vacuum your floor before using your steam mop.

A. Pull and twist the quick release cord holder to unwrap the power cord completely. Plug into electrical outlet.

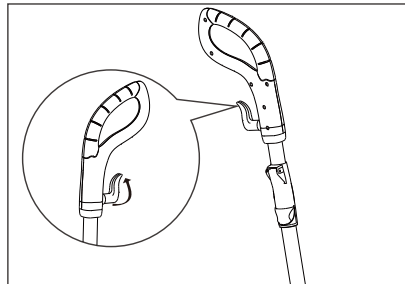

B. After plug-in electric, turn on the switch, the button will light red. (" I " means turn on, " O " means turn off)

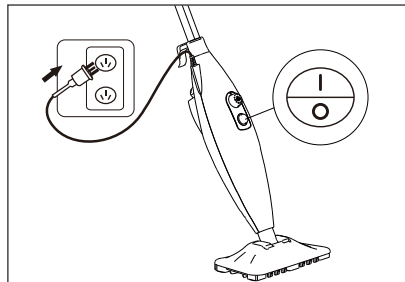

Product Operation

C. Selecting your steam setting

- Press " I " button for steam mop to start. The switch will light red signal.
- After 30 seconds, wait for the initial steam to come out from the mop, then you can start using.
- There are 10 different steam options to choose from left to right. Simply roll the roller to adjust the steam. (Left is for maximum steam, right is for minimum steam.)

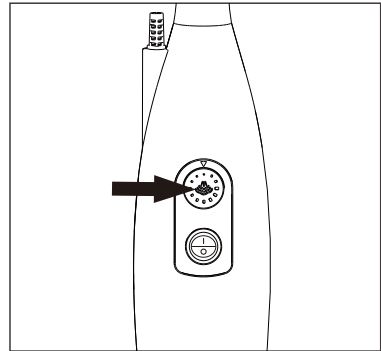

D. Clean your floors with a forward and backward motion.

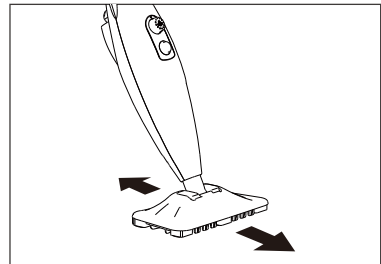

E. Press " O " off button until red light disappears to stop steam.

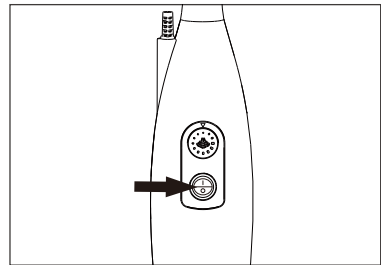

Automatic shutdown function

Our steam mop has Automatic Stand By / Shutdown Function, which is helpful to protect your floor against damage by over heat.

- 1 When the steam mop stand at nearly upright (angle 70-90 degrees) for 15 seconds , the until will stand by ; Any motion will let the until work again .
- 2 When the until stand by and continue motionless more than 120 seconds , the until will shut off . You need to press the ON / OFF button to resume steaming .

Maintenance skills

! Attention!

Please wait 2-3 minutes for the steam mop to cool off before removing the mop head or the micro-fiber cleaning pad. Never leave the steam mop with a damp / wet micro-fiber cleaning pad on the same place for a long time.

- When the microfiber cleaning pad gets dirty, please change a new one to continue cleaning with a fresh pad.
- When the water tank is empty, the steam mop will stop producing steam.
- You can refill the water tank at any time as long as the mop is unplugged from the outlet. Follow the instructions on page 6 .

Common Failure Analysis and Treatment

Care of your steam mop

After use and storage

1. Press the ON / OFF button to switch off the unit after use.
2. Unplug the cord from the outlet and place the mop into the upright position.
3. Let the unit cool for 2-3 minutes.
4. Remove the cleaning pad.
5. Empty the water tank before storage. Remove the water tank cap and empty the tank over a sink. Replace the water cap.
6. To store the steam mop hanging up, first remove the head (after it has cooled and the steam has cooled and the steam has been released) then hang on a large hook.

Care of your micro-fiber cleaning pad

1. We recommend washing your micro-fiber cleaning pad separately from other fabrics to avoid picking up lint. Only use liquid detergent (no powder detergent). Do not use any fabric softeners or bleach. Line dry on a low dryer setting.
2. If there are loose threads on the micro-fiber cleaning pad carefully cut the thread with scissors. Do not pull on them or cut at the base.



Note:

Calcium and mineral deposits can build up and impact the over time. To extend the life of your product. We recommend that you use distilled water or filtration water.

Troubleshooting

Check out the contents below to deal with the abnormal problem when the device doesn't work normally.

Malfunction	Solution
The unit will not turn on.	Your steam mop should be securely plugged into a 220V-240V AC electrical outlet only.
The unit will not make steam.	<ol style="list-style-type: none">1. Check is there water in water tank.2. If you have already plugged in your unit,unplug and try a different outlet.This may reset the standby mode.
The steam mop may leave water on the floor after steaming.	Do not leave your steam mop on the floor with a damp cleaning pad for a long time.Make sure the cap is securely on the water tank.
Floors are cloudy, streaky or spotty after steaming.	<ol style="list-style-type: none">1. The micro-fiber cleaning pad might be dirty, change the cleaning pad.2. Do not use powder detergent to wash the cleaning pads,because it will affect the pad's cleaning effect.3. You might have left the mop in the same spot for too long.This might be leftover from past cleaners used on the floor surface.Use the steam mop a few more times and see if cloudiness removed.4. If this does not work,we suggest rinsing the floor with water,letting it dry,and then steam mopping again with a clean pad,one or more rinses generally removes the residue.
The steam mop is hard to push	Make sure the micro-fiber cleaning pad is attached correctly.Check to see if the cleaning pad is excessively dirty.If so,replace the cleaning pad.

Product Technical Parameters

Item	Steam Mop
Model	S50
Net weight	2.2kg
Water capacity	0.45L
Dimension	443 X 78 X 73mm
Rated voltage	220V-240V 50Hz
Rated power	1300W

Disposal Information

Disposal

The battery used with this device must not be disposed of in household waste. The device and the battery must be disposed of properly. The housing of the battery must never be opened, and must be disposed of as a whole.



This product is subject to the provisions of European Directive 2019/19/EC. The symbol showing a wheelie bin crossed through indicates that the product requires separate refuse collection in the European Union. This applies to the product and all accessories marked with this symbol.



Products identified with this symbol may not be discarded with normal household waste, but must be taken to a collection point for recycling electric and electronic appliances.



Packaging

When disposing of the packaging, make sure you comply with the environmental regulations applicable in your country.

Distributor: Zhiyi (Zhongshan) Technology Co., Ltd.

No. 39, Donghui Road, Cuiheng New District, 528400 Zhongshan, Guangdong,
PEOPLE'S REPUBLIC OF CHINA

● EASINE Customer Service

Russia

 **89299401228** (Mon-Fri: 9:00 - 18:00)

 support-russia@easine.com

Other countries

 support-europe@easine.com

